



RIDGEWAY

RESIDENTIAL SERVICES



29 Chaise Meadow

, Lymm, WA13 9NX

£129,950



Floor Plan

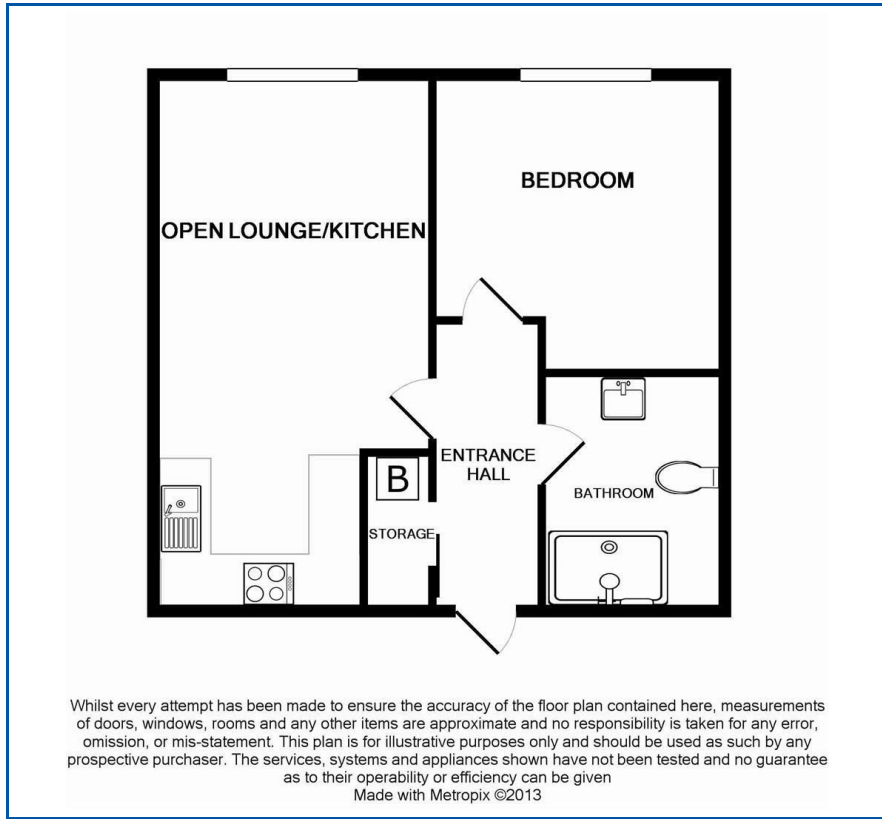

Area Map



Energy Efficiency Graph

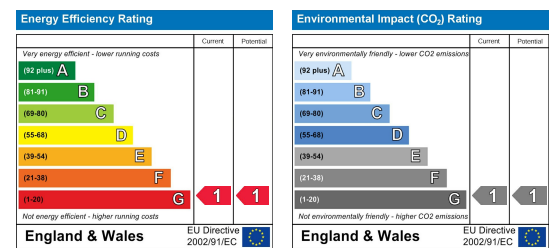

Viewing

Please contact us on 01925 756931 if you wish to arrange a viewing appointment for this property or require further information.

- First Floor Apartment
- Open Plan lounge/Dinner
- Bathroom
- Gas Central Heating
- Viewing Recommended
- Entrance Hallway
- Double Bedroom
- Allocated Parking
- Priced To Sell

First floor modern apartment in popular location within easy reach of Lymm village, entrance hall, large storage cupboard, open plan lounge with double opening doors and fitted kitchen, double bedroom, bathroom. Allocated parking. Gas central heating. Double glazed. Alarmed.

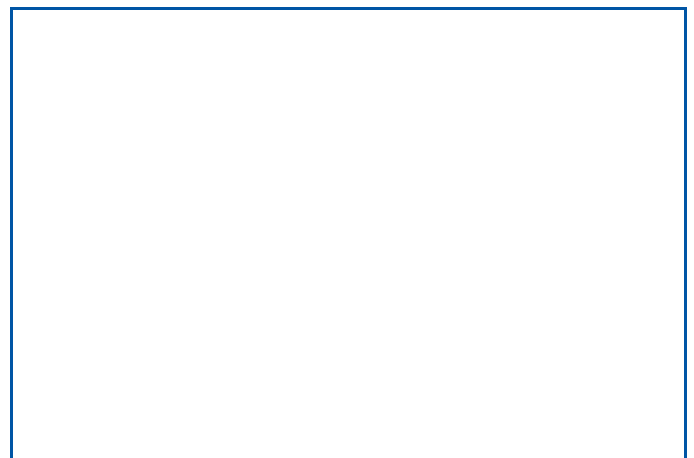
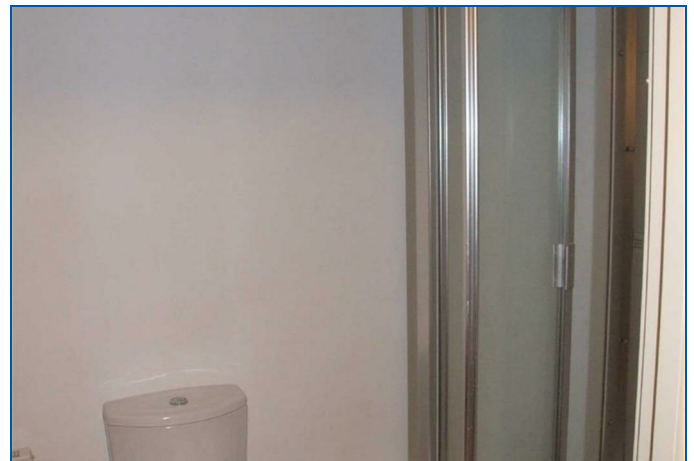

These particulars, whilst believed to be accurate are set out as a general outline only for guidance and do not constitute any part of an offer or contract. Intending purchasers should not rely on them as statements of representation of fact, but must satisfy themselves by inspection or otherwise as to their accuracy. No person in this firm's employment has the authority to make or give any representation or warranty in respect of the property.